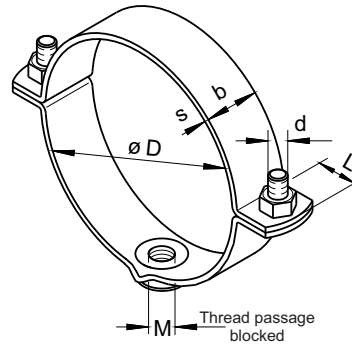

**SCREW-ON PIPE CLAMP**Type **114 Ni**

two pieces

dipa

**Mounting example**

All dimensions in mm

Permissible tensile strength* [kg]						
Material	until nominal diameter					
b x s	38.0	60.3	90.0	150.0	500.0	1000.0
20x1,5	150					
20x2,0						
30x2,5				300	280	170

\* valid for ceiling mounting usage only with tube types who do not deform themselves at mentioned load factors.

**Description**

Two pieces pipe clamp made of zinc-coated band steel with punched pipe clamp connection screws. Suitable for all pipe types. For usage with copper pipes the pipe clamp receives a glass fibre inlay. The glass fibre is resistant to constant temperatures up to 500°C. The chosen rivet connection for the screw-on thread is highly resilient and in opposition to weld connections easily manageable. Rivet nut and band steel are separately zinc-coated. Therefore rust occurrence at the rivets can be eliminated.

Deliverable in diameter range from 15 mm until 1000 mm.

**Combination possibilities with Type**

102a, 104G, 105 and 106

**Preferable fields of application**

Air-, climate-, sanitary- and heating technology

Material b x s	$\varnothing D$	Thread connection M	d	L
20x1,5	15.0 17.2 18.0 consecutive pipe diameter until 38.0	M 8	M 6	15
20x2,0	42.0 42.4 44.5 consecutive pipe diameter until 60.3	M 8	M 6	15
30x2,5	63.0 64.0 70.0 consecutive pipe diameter until 450.0	M 8	M 8	21
30x2,5	80.0 88.9 90.0 consecutive pipe diameter until 1000.0	M10	M 8	21

**Other diameters on request.  
Please tell us the requested  
pipe diameter.**